

Bluetouch  
Communicator  
USER GUIDE

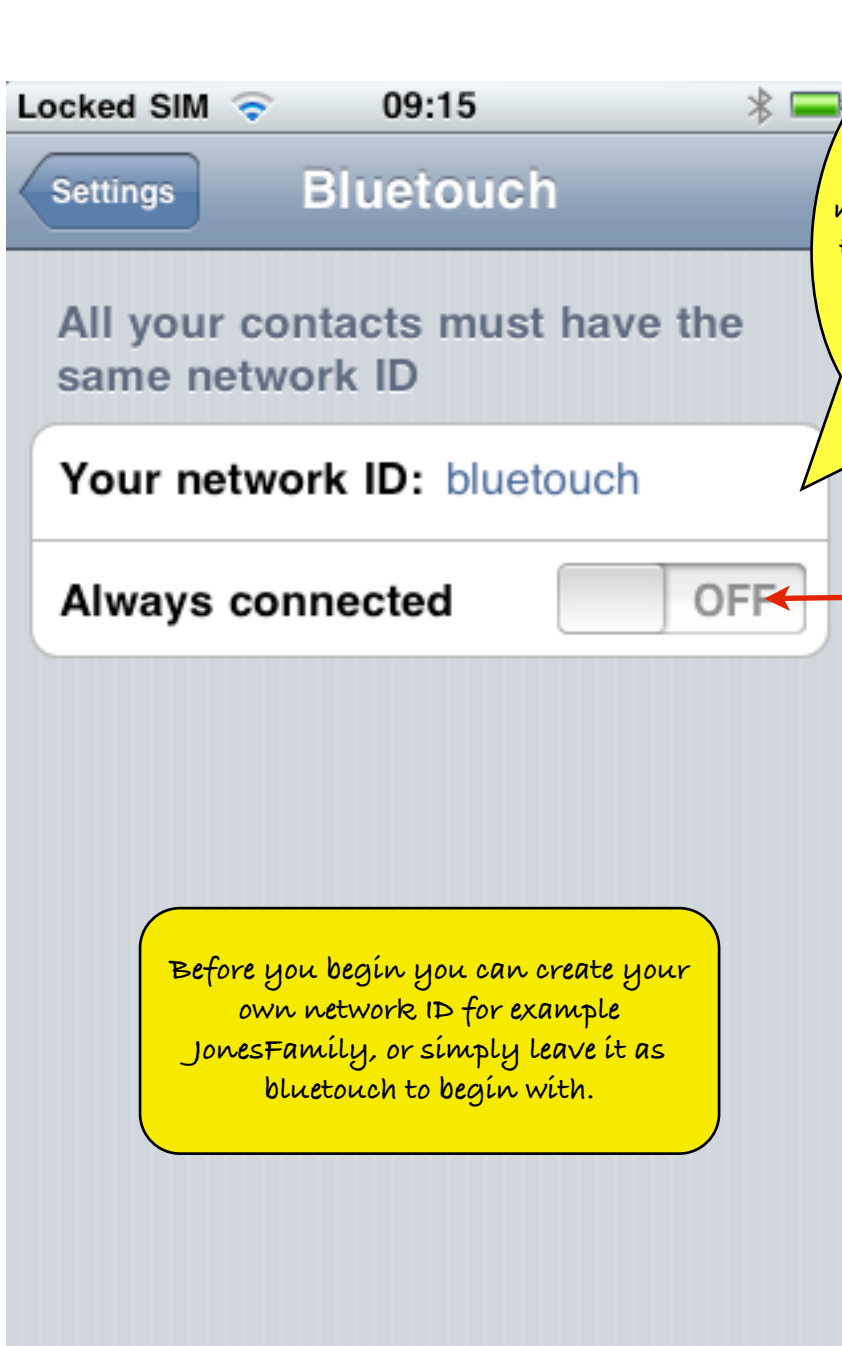

Go to the Settings and give your contact group a network ID name, so that those in this group only will be able to contact you, and vice versa. The default is bluetouch.

This feature is not yet

Before you begin you can create your own network ID for example JonesFamily, or simply leave it as bluetouch to begin with.

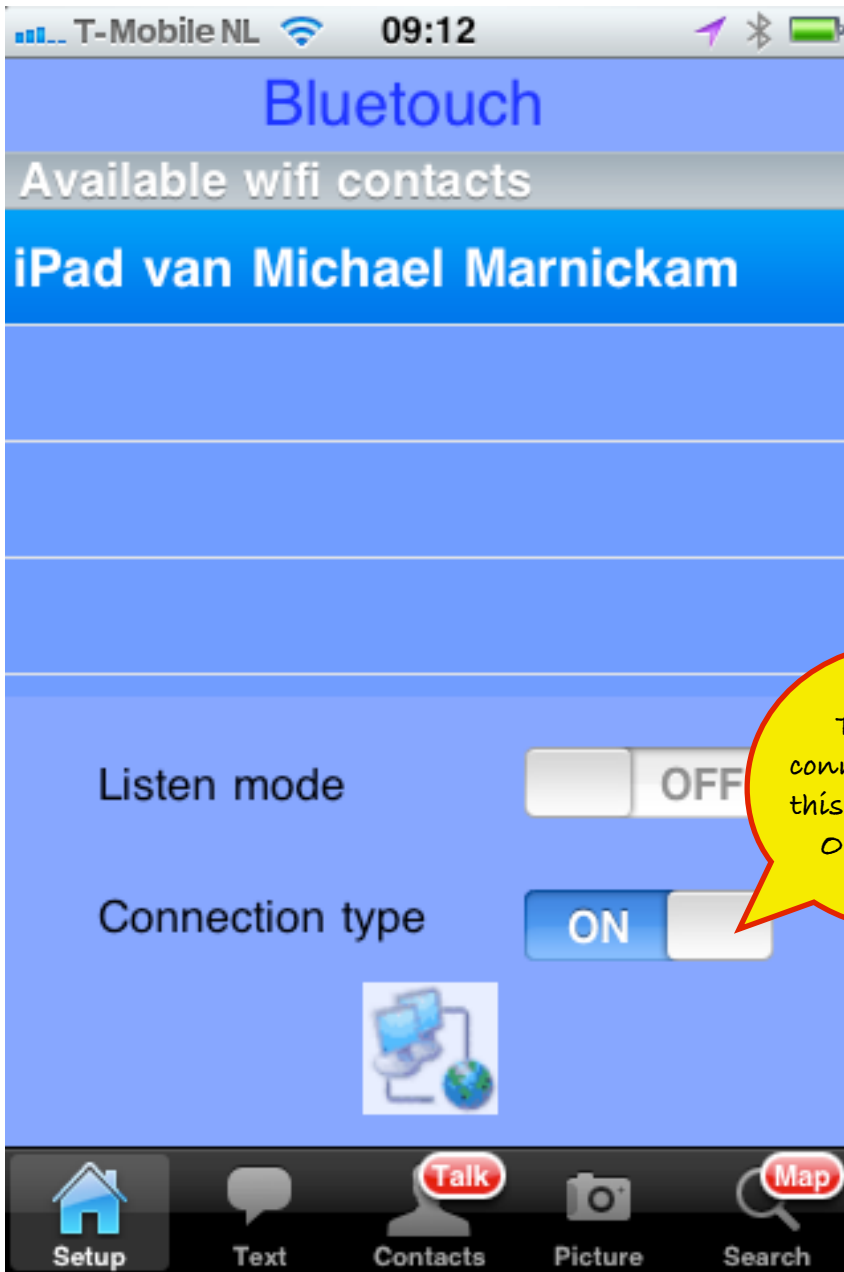

To make a connection, slide this switch to the ON position

Select this menu to go to the connection screen.

Locked SIM

08:48

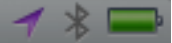

# Bluetooth

Available

Select Online for lan connections or Nearby for Bluetooth connections



Online



Nearby

Listen mode

OFF

Cancel

Connection type

When a connection is made the X disappears.



Setup



Text



Contacts



Picture



Search



You select the contact you want to make by clicking on the name here.

By switching to ON, the other party receives your name and makes the connection. This method is usually easier. Note: You must switch this to ON before switching ON Connection type to use this mode.

This shows that the connection is made

Locked SIM



09:16



# Bluetouch

Available wifi contacts

**iPhone van Michael Marnickam**

**Incoming Invite from iPhone  
van Michael Marnickam**

Do you want to connect?

List **Accept**

**Decline**

Click here to  
connect and wait  
until the X below  
dissappears

Connection type

ON



Setup



Text

Talk



Contacts



Picture



Search

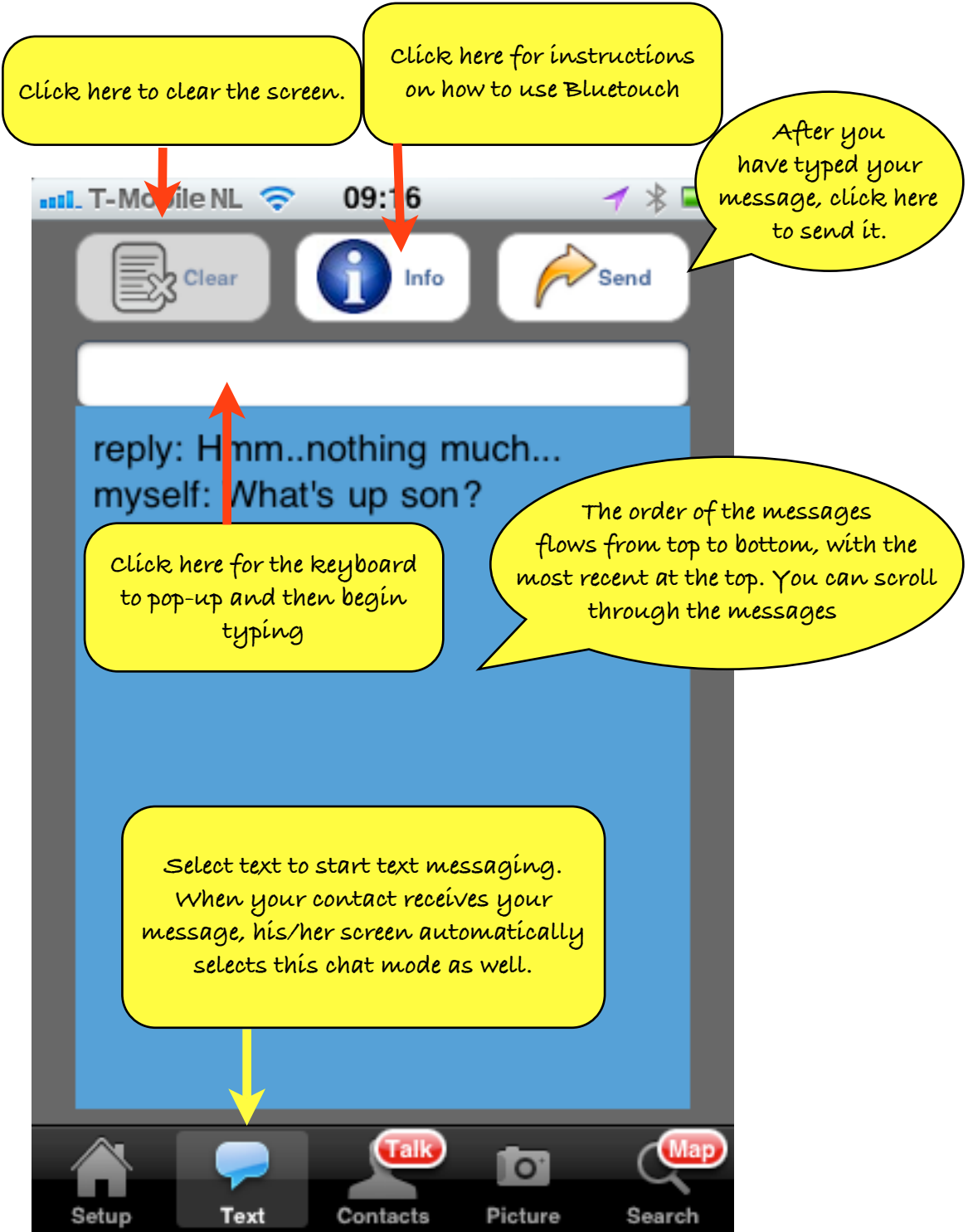

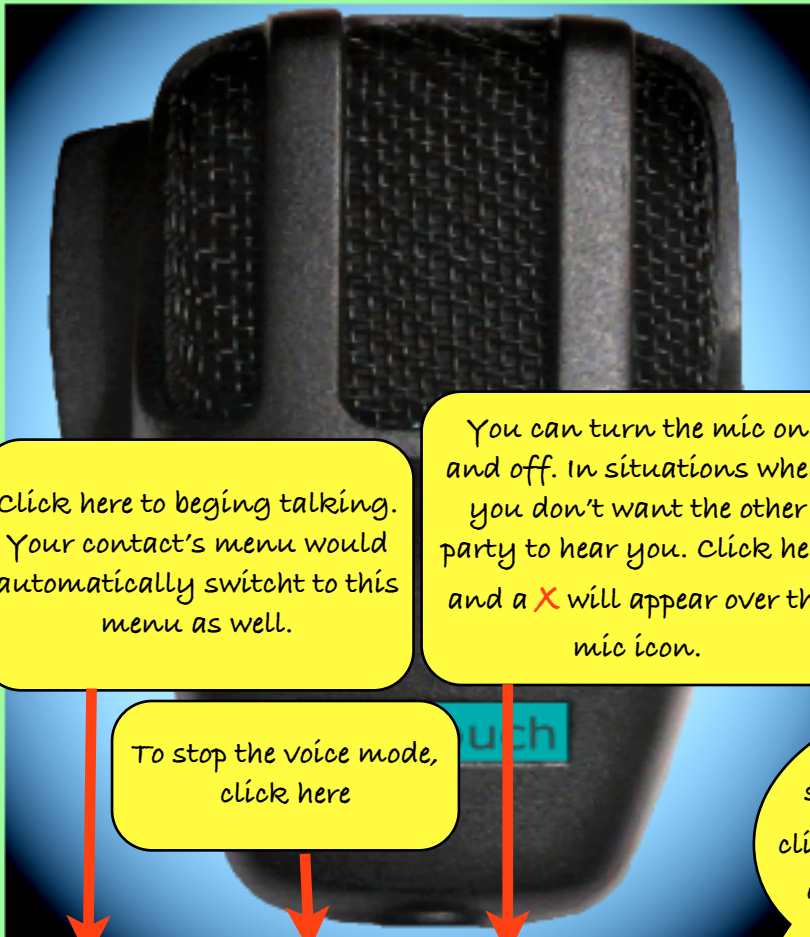

Click here to begin talking. Your contact's menu would automatically switch to this menu as well.

You can turn the mic on and off. In situations when you don't want the other party to hear you. Click here and a **X** will appear over the mic icon.

To stop the voice mode, click here

You can turn the speakerphone on and off by clicking here. An **X** will appear over the speaker icon if it is off.



Choose this menu to start the voice/talk mode





Click here to send, and the picture on the screen will be sent to the other party.

Received pictures can be saved in the photo album by clicking here.

You can also select pictures from the photo album by clicking here.

Click here to select the camera. After taking a picture, it will appear on the screen.

Choose this menu to select the camera/ picture mode

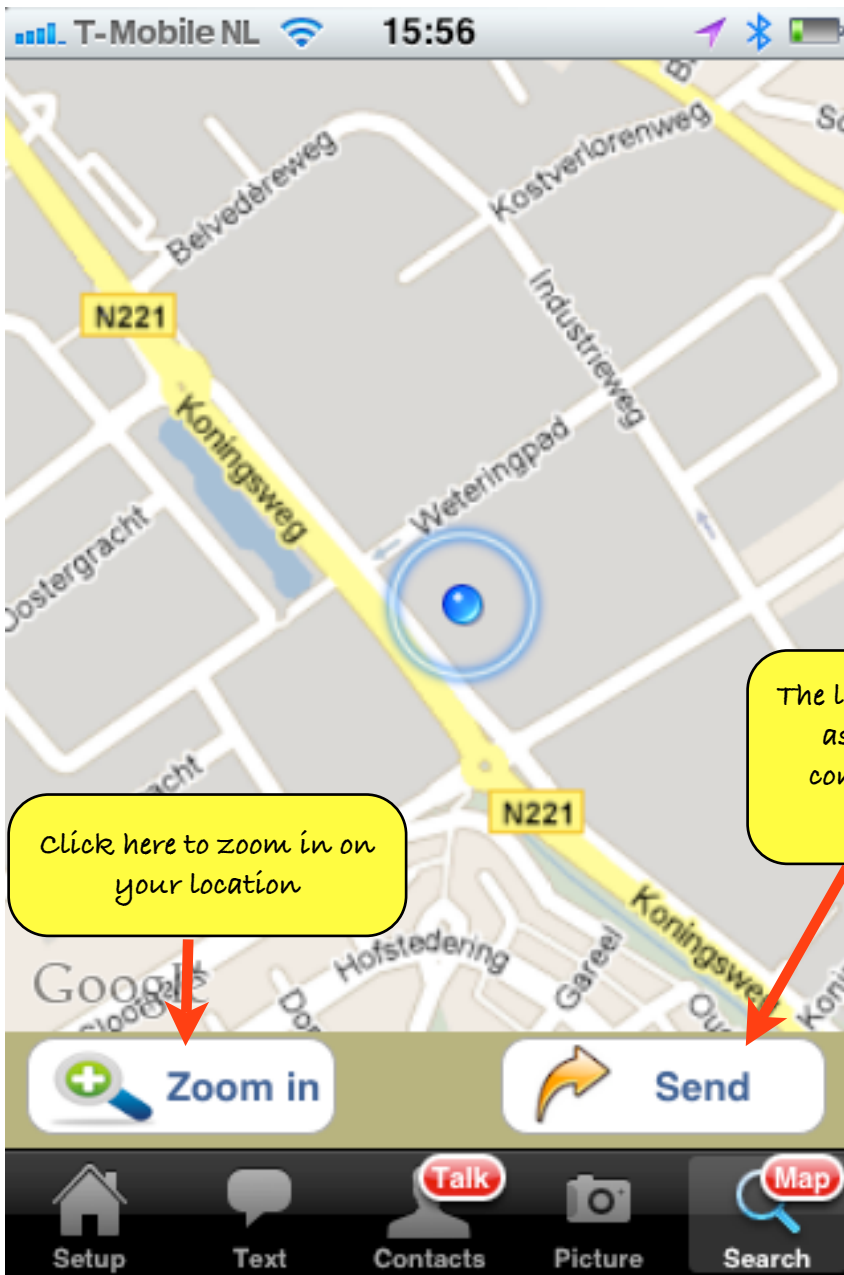

Click here to zoom in on your location

The location can be sent as a picture to the connected party by clicking here.

Choose this menu to select the map/gps mode

# Bluetouch Communicator

All rights reserved  
Marnickam Technology  
Koningsweg 20-3  
3762EC Soest  
The Netherlands